

# Lecture Venues

The IET Sussex Network holds technical talks in both Crawley, at Crawley College, and in the south of Sussex either at Worthing College or at the University of Sussex Falmer campus, using a number of lecture theatres. The location of any particular talk is given on the registration page, accessed from the Sussex Network's home page. This document provides details of how to locate the various venues.

Click on the page number below to go to details of that venue.

Crawley College .....	1
Worthing College.....	2
University of Sussex, Falmer .....	3
Jubilee Building .....	4
Fulton Building .....	5
John Maynard Smith Building .....	5

## Crawley College

At Crawley College we use the Immersive Space room on the ground floor of the Longely 2 building. Parking is free after 6pm, but note that the main car park, off Haslett Avenue East, is partly a building site, reducing the number of available parking spaces. If there are no spaces then you can park in the Library car park opposite for free after 6pm. Alternatively, there is a Crawley College visitor's car park off College Road.

Enter the building in the corner and turn left, down the corridor to the Immersive Space room. From the entrance, toilets are to the right.



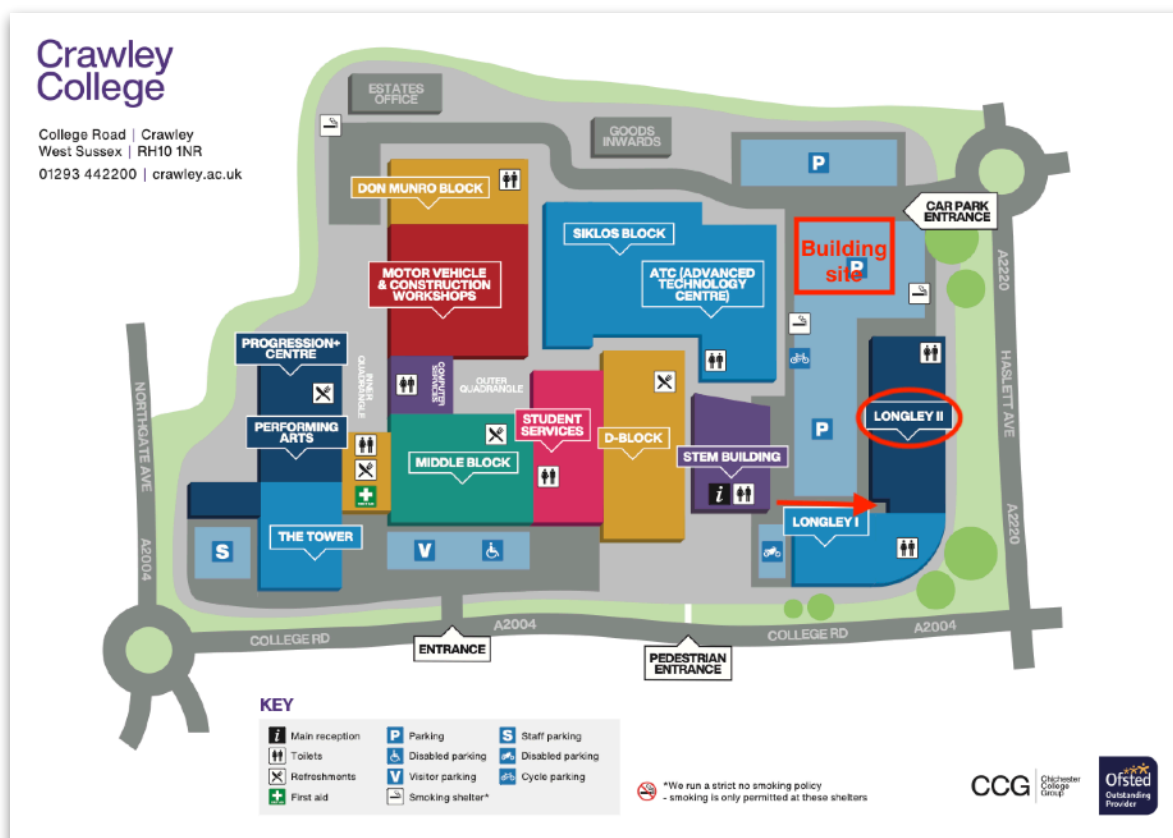

# Worthing College

This is a new venue for the 2025/26 season of talks. As you can see from the map, the college is just off the Grove Lodge roundabout on the A27. Look out for speed bumps on Hill Barn Lane. Entrance to the college is then on the left.

Parking is free and the entrance to the college is a short walk from the car park, as shown on the image below. The room is on the first floor, up the stairs on the right.

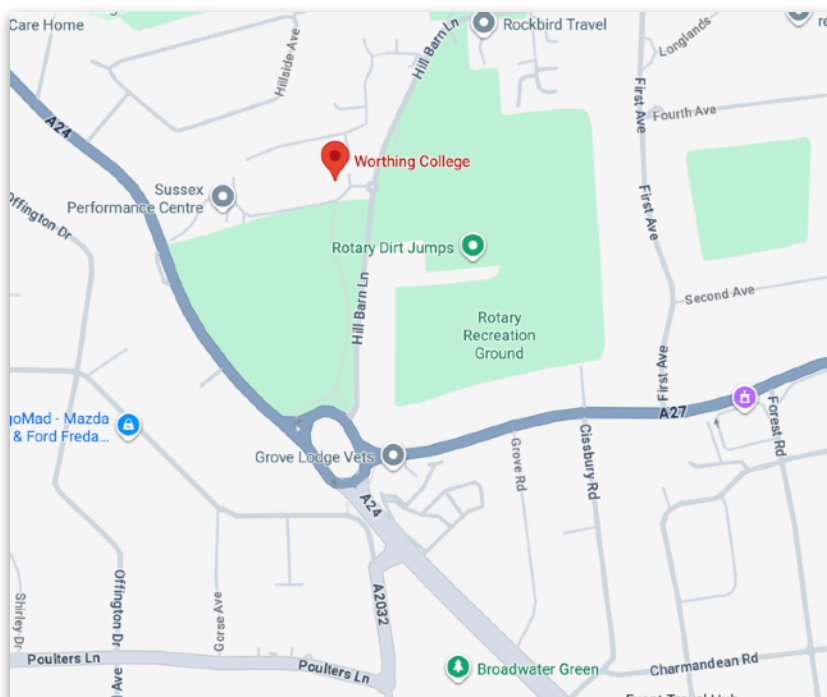



## University of Sussex, Falmer

Please be aware that we now have to pay for parking on the Falmer campus.

Payment can only be made using the PayByPhone application. You can download this from the App Store or Google Play onto your phone. Under settings in the top right of the app you can add your car and card details.

When you arrive at the car park:

- In 'Find parking' on the home page add the car park location number (displayed on the car park sign).
- Enter parking duration.
- Select Pay & Park.

According to the University of Sussex web site, parking between 5pm and 9am is a flat fee of £4.50. Car park P4, Sussex House, is location 800803 and P7, Jubilee multi-story, is location 800850.

We strongly recommend that you download the app and enter your car and card details before arriving at Falmer.

A map showing the location of the visitor's car parks (4 and 7) is below and a full University of Sussex Falmer campus map can be downloaded [here](#).



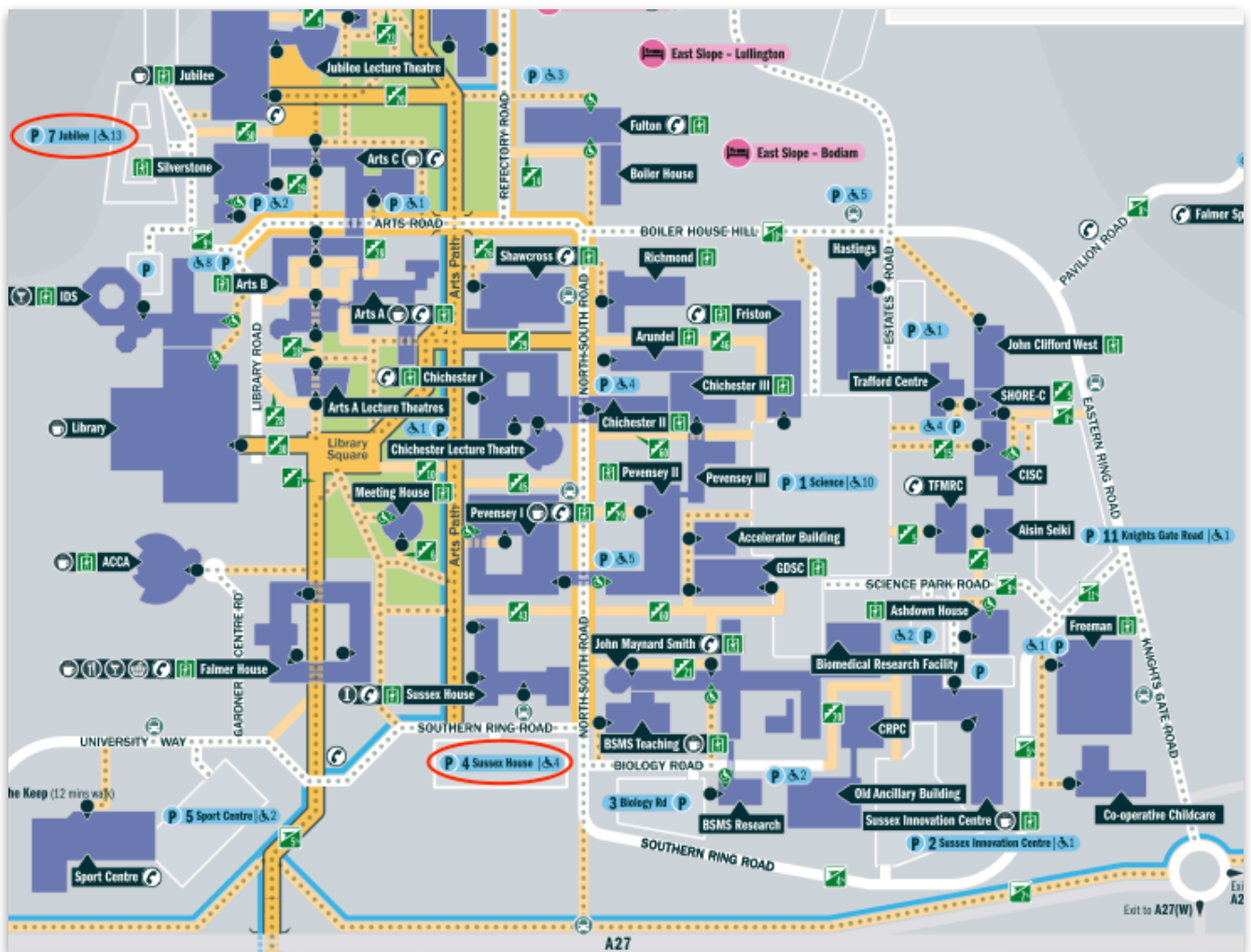

## Jubilee Building

The Jubilee building is close to the multi-storey car park 7. From the car park, walk across to the small door at the end of the building (you need to press the large button on a post in order to open the door). Once inside, turn left and walk along the corridor to the central stairwell. Cross to the other side and turn right to get to the lecture theatre (144). If going in via the main entrance then you

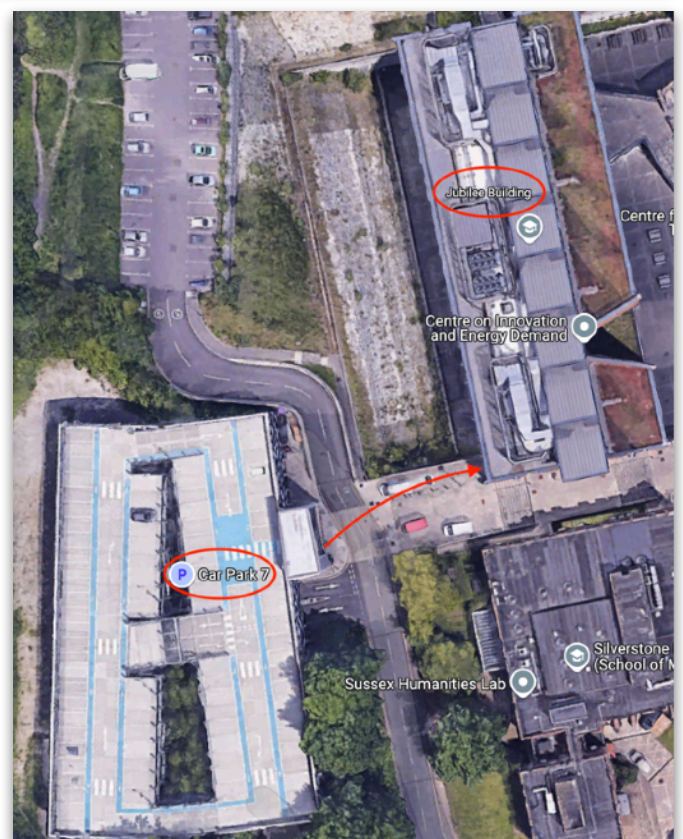
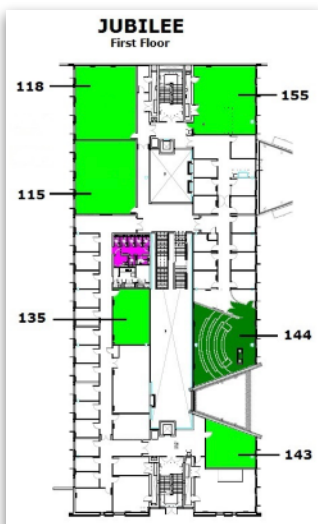



need to go up to the first floor.

## Fulton Building

The Fulton A lecture theatre is our preferred venue, since there is a good space for refreshments and networking, but it is not always available to us. There is also a Fulton B next to it.

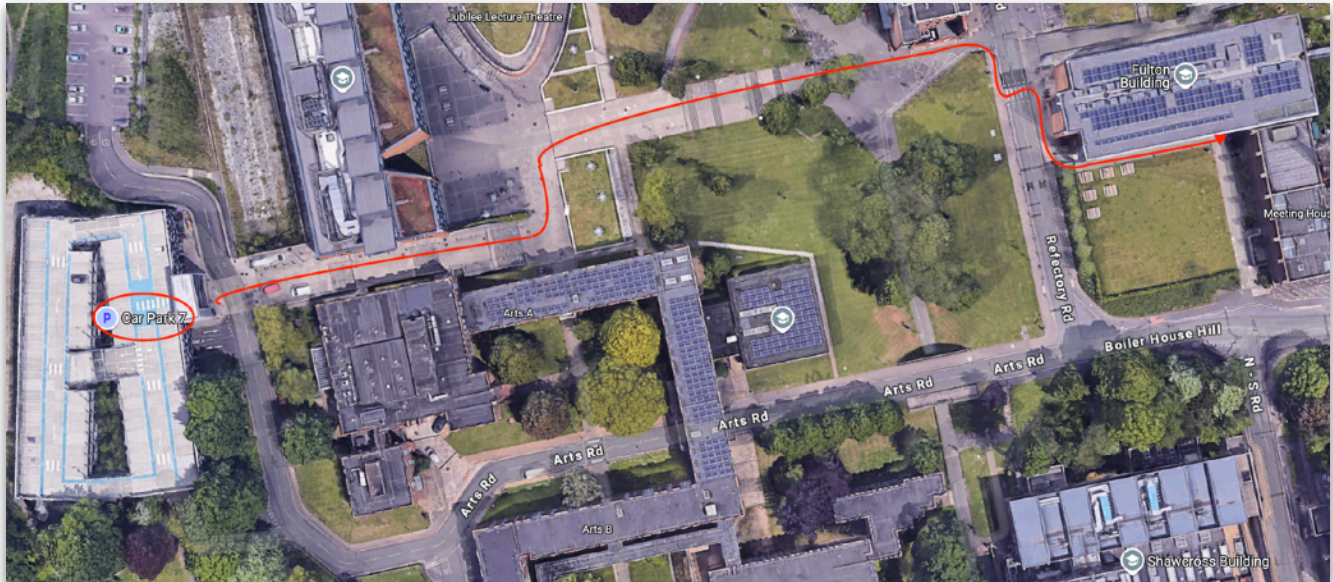

Car park 7, the multi-story, is the nearest, although the route to Fulton A (as marked above in red) is somewhat tortuous. You can, however, approach it along the path from the end of North-South Road.

## John Maynard Smith Building

As you can see in the image, the Big Lecture Theatre in the John Maynard Smith building is quite close to car park number 4. Note, however, that the location number (800803) is on a notice attached to a lamppost and not on the main car park notice.

